

INSTALL THESE OR OTHER WARNING SIGNS AS NEEDED FOR THE SPECIFIC HAZARD.

W20-4 48" x 48" B/O	W8-1501 48" x 48" B/Y	R11-4 5' x 30" B/W	R1-2 36" x 36" R/W	W8-1 48" x 48" B/O	W8-1801 48" x 48" B/O	W21-1701 48" x 48" B/O	W21-801 48" x 48" B/O

PCMS	
1	2
CAUTION STORM DEBRIS	ON ROAD NEXT XX MILES
1.5 SEC	1.5 SEC

FIELD LOCATE IN ADVANCE OF DEBRIS

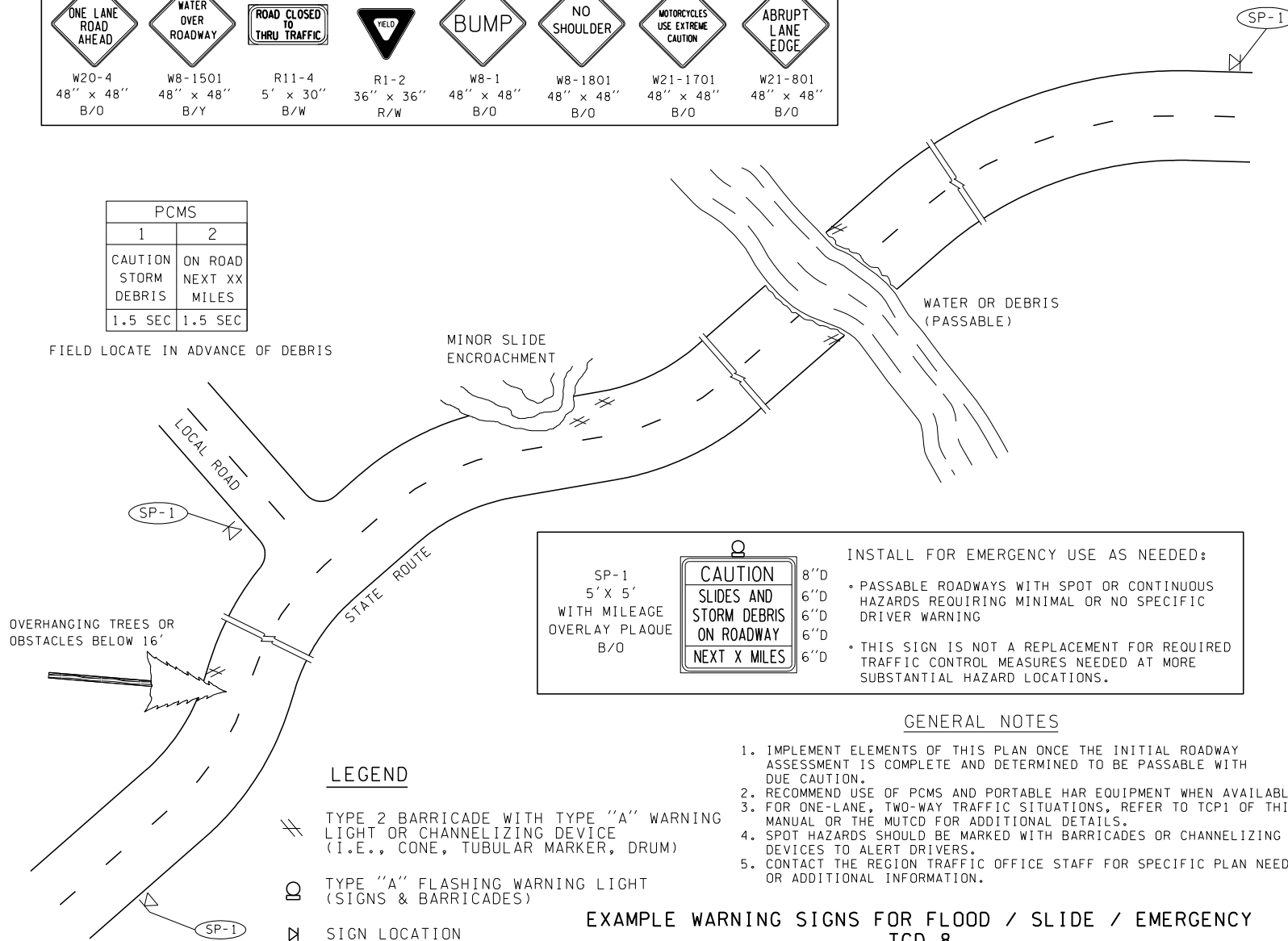

SP-1 5' X 5' WITH MILEAGE OVERLAY PLAQUE B/O		8"D 6"D 6"D 6"D 6"D	INSTALL FOR EMERGENCY USE AS NEEDED:
			<ul style="list-style-type: none"> PASSABLE ROADWAYS WITH SPOT OR CONTINUOUS HAZARDS REQUIRING MINIMAL OR NO SPECIFIC DRIVER WARNING THIS SIGN IS NOT A REPLACEMENT FOR REQUIRED TRAFFIC CONTROL MEASURES NEEDED AT MORE SUBSTANTIAL HAZARD LOCATIONS.

GENERAL NOTES

- IMPLEMENT ELEMENTS OF THIS PLAN ONCE THE INITIAL ROADWAY ASSESSMENT IS COMPLETE AND DETERMINED TO BE PASSABLE WITH DUE CAUTION.
- RECOMMEND USE OF PCMS AND PORTABLE HAR EQUIPMENT WHEN AVAILABLE.
- FOR ONE-LANE, TWO-WAY TRAFFIC SITUATIONS, REFER TO TCP1 OF THIS MANUAL OR THE MUTCD FOR ADDITIONAL DETAILS.
- SPOT HAZARDS SHOULD BE MARKED WITH BARRICADES OR CHANNELIZING DEVICES TO ALERT DRIVERS.
- CONTACT THE REGION TRAFFIC OFFICE STAFF FOR SPECIFIC PLAN NEEDS OR ADDITIONAL INFORMATION.

LEGEND

- TYPE 2 BARRICADE WITH TYPE "A" WARNING LIGHT OR CHANNELIZING DEVICE (I.E., CONE, TUBULAR MARKER, DRUM)
- TYPE "A" FLASHING WARNING LIGHT (SIGNS & BARRICADES)
- SIGN LOCATION

EXAMPLE WARNING SIGNS FOR FLOOD / SLIDE / EMERGENCY
TCD 8