

POSTED SPEED	DECELERATION LENGTH NEEDED TO REACH LISTED ADVISORY SPEED - MPH = D					
	10	20	30	40	50	60
70	525	500	425	350	250	150
65	425	400	350	175	N/A*	N/A*
60	350	300	250	175	N/A*	--
55	275	225	175	100	N/A*	--
50	200	150	100	N/A*	--	--
45	125	N/A*	N/A*	--	--	--
40	N/A*	N/A*	N/A*	--	--	--
35	N/A*	N/A*	N/A*	--	--	--
30	N/A*	N/A*	--	--	--	--
25	N/A*	--	--	--	--	--

* NO SUGGESTED MINIMUM DISTANCES ARE PROVIDED FOR THESE SPEEDS, AS THE PLACEMENT LOCATION IS DEPENDENT ON SITE CONDITIONS AND OTHER SIGNING TO PROVIDE AN ADEQUATE ADVANCE WARNING FOR THE DRIVER.

SIGN SPACING = X (feet) (1)		
Freeways & Expressways	55/70 MPH	1500'+- (OR AS PER MUTCD)
Rural Highways	60/65 MPH	800'+-
Rural Roads	45/55 MPH	500'+-
Rural Roads & Urban Arterials	35/40 MPH	350'+-
Rural Roads, Urban Arterials Residential & Business Districts	25/30 MPH	200'+- (2)
Urban Streets	25 MPH or LESS	100'+- (2)

ALL SIGNS ARE 48" x 48" BLACK ON ORANGE UNLESS OTHERWISE DESIGNATED.

(1) All spacing may be adjusted to accommodate interchange ramps, at-grade intersections, and driveways.
(2) This spacing may be reduced in urban areas to fit roadway conditions.

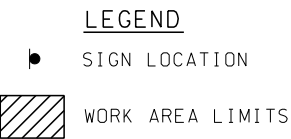
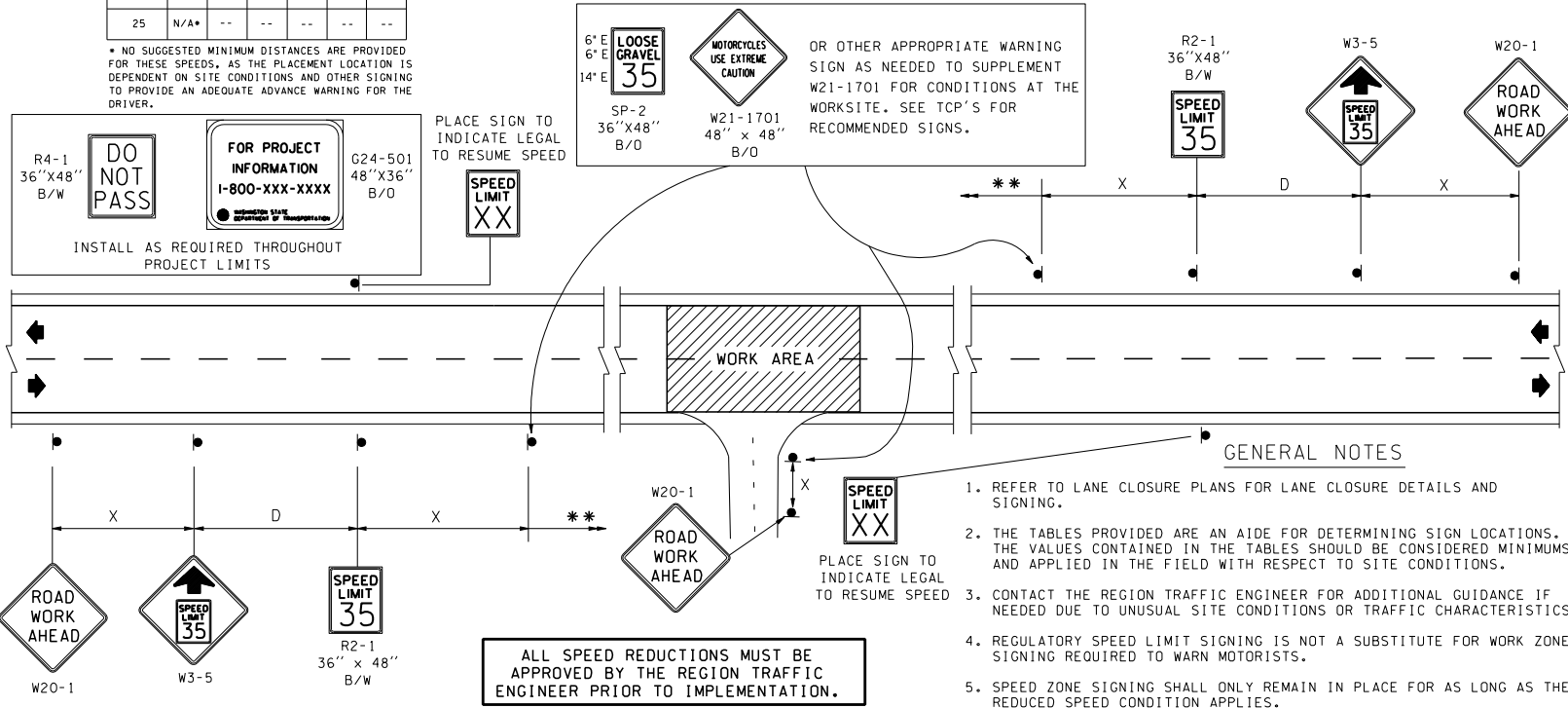
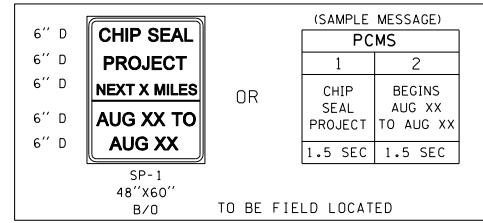

ALL SPEED REDUCTIONS MUST BE APPROVED BY THE REGION TRAFFIC ENGINEER PRIOR TO IMPLEMENTATION.

** CONTINUE SIGNS AS NEEDED BASED ON REQUIRED ROADWAY CONDITION WARNING AS SHOWN ON THE APPROPRIATE TCP.

TYPICAL SPEEDZONE DETAIL
CHIP SEAL PROJECTS
TCD 4

- GENERAL NOTES**
1. REFER TO LANE CLOSURE PLANS FOR LANE CLOSURE DETAILS AND SIGNING.
 2. THE TABLES PROVIDED ARE AN AIDE FOR DETERMINING SIGN LOCATIONS. THE VALUES CONTAINED IN THE TABLES SHOULD BE CONSIDERED MINIMUMS AND APPLIED IN THE FIELD WITH RESPECT TO SITE CONDITIONS.
 3. CONTACT THE REGION TRAFFIC ENGINEER FOR ADDITIONAL GUIDANCE IF NEEDED DUE TO UNUSUAL SITE CONDITIONS OR TRAFFIC CHARACTERISTICS.
 4. REGULATORY SPEED LIMIT SIGNING IS NOT A SUBSTITUTE FOR WORK ZONE SIGNING REQUIRED TO WARN MOTORISTS.
 5. SPEED ZONE SIGNING SHALL ONLY REMAIN IN PLACE FOR AS LONG AS THE REDUCED SPEED CONDITION APPLIES.
 6. CONTACT THE REGION TRAFFIC OFFICE FOR SPECIAL SIGN ORDERS, SPEED REDUCTION NOTICES, ETC.
 7. SEE TCD9 FOR TEMPORARY PAVEMENT MARKING DETAILS.
 8. MOTORCYCLE WARNING SIGNS ARE REQUIRED AS PER WAC 468-95-305.
 9. SPEED LIMIT REDUCTION SHALL CONFORM TO RCW 47.48.020