

WORK OPERATIONS THAT REMOVE OR OBSCURE EXISTING PAVEMENT MARKINGS MUST PROVIDE FOR TEMPORARY MARKINGS UNTIL THE PERMANENT MARKINGS ARE APPLIED. TEMPORARY MARKINGS MAY BE USED UNTIL IT IS PRACTICAL AND POSSIBLE TO INSTALL PERMANENT MARKINGS. THE DETAILS BELOW SHOW VARIOUS COMMON APPLICATIONS. CONTACT THE REGION TRAFFIC OFFICE FOR ASSISTANCE WITH MORE COMPLEX SITUATIONS.

MULTI-LANE ROADWAYS

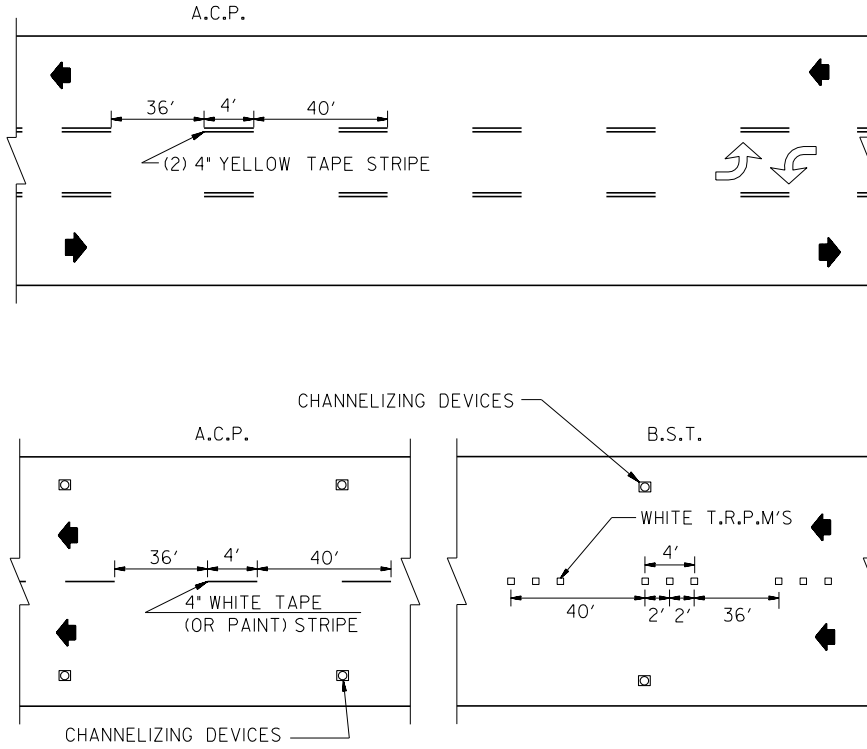

2 LANE ROADWAYS

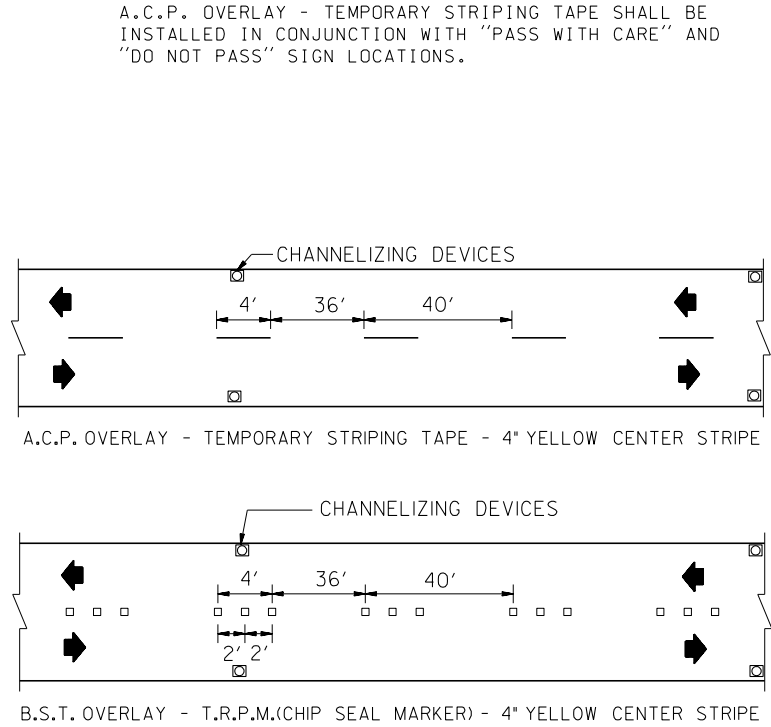

A.C.P. OVERLAY - TEMPORARY STRIPING TAPE SHALL BE INSTALLED IN CONJUNCTION WITH "PASS WITH CARE" AND "DO NOT PASS" SIGN LOCATIONS.

A.C.P. OVERLAY - TEMPORARY STRIPING TAPE - 4" YELLOW CENTER STRIPE

B.S.T. OVERLAY - T.R.P.M.(CHIP SEAL MARKER) - 4" YELLOW CENTER STRIPE

TEMPORARY EDGE STRIPES ARE NOT REQUIRED FOR THE ABOVE SITUATIONS BUT IF USED, T.R.P.M.'S MAY BE USED ON A PATTERN SPACING OF 5' O.C. TO SIMULATE A SOLID LINE. TEMPORARY ROADSIDE DELINEATION WITH CHANNELIZATION DEVICES SHOULD BE CONSIDERED, BUT ARE OPTIONAL. DO NOT USE A "SKIP" PATTERN OF TAPE STRIPE TO SIMULATE AN EDGE STRIPE. FOR LONG TERM PROJECTS, A TEMPORARY CHANNELIZATION/PAVEMENT MARKING PLAN SHOULD BE DEVELOPED.

CHANNELIZATION DEVICE SPACING - TANGENT 200' +-
CURVES 100' +-
TAPERS 1/2 L

T.R.P.M. = TEMPORARY RAISED PAVEMENT MARKER

TEMPORARY PAVEMENT MARKING DETAILS
TCD 9